

Vacant

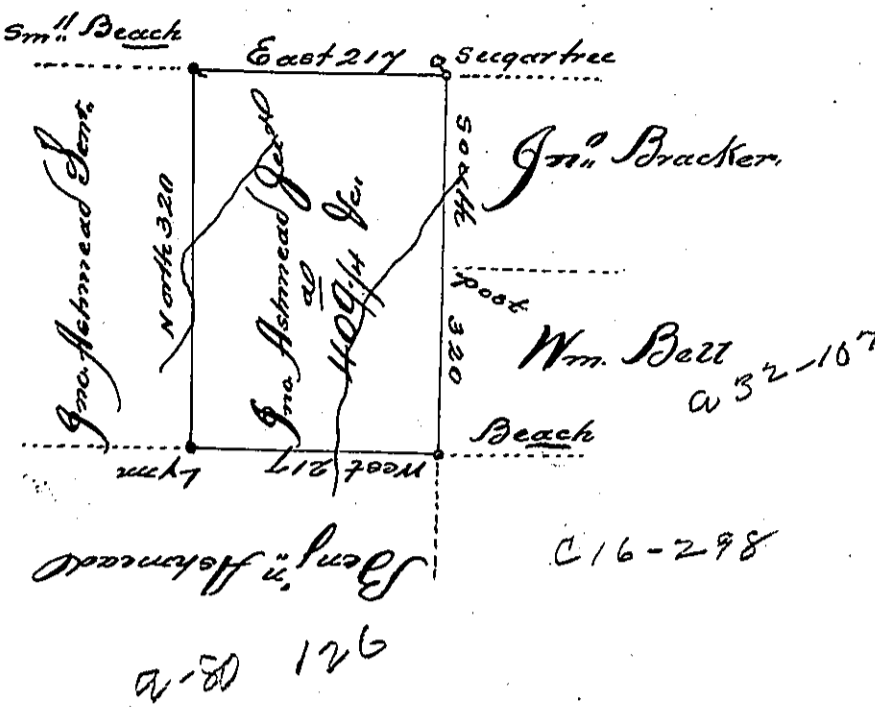

A Draught of a Tract of land situated on the waters of Loyalsock Creek, adjoining land of John Bracker & others in Loyalsock Township in the County of Northumberland, surveyed on the 17th day of November 1788 for John Ashmead Junr in pursuance of his warrant bearing date on the first day of July 1781 containing Four Hundred & nine acres & one quarter & the allowance of six p. Cent for Roads &c.

This warrant was removed from the waters of Catawassa Creek, the land being appropriated, as appears by a Certificate from under the Hand of the Deputy Surveyor of that District &c

To John Lukens Esq.
Surveyor Genl.

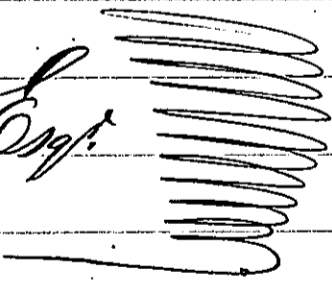

J. J. Wallis Esq.

IN TESTIMONY that the above is a copy of the original remaining on file in the Department of Internal Affairs of Pennsylvania, made conformably to an Act of Assembly approved the 16th day of February, 1833, I have hereunto set my Hand and caused the Seal of said Department to be affixed at Harrisburg, this first day of April, 1902,

James W. Pitta
Secretary of Internal Affairs.